



ALPIN CHALET LARGE - FILZMOOS & KLEINARL



ALPIN-CHALET.COM



COOKING & LIVING IN THE ALPIN LOFT

ALPIN-CHALET LARGE

The new ALPIN CHALET "Large" is a combination between a classic ALPIN CHALET and the XL ALPIN CHALETs. It's almost the size of its bigger brother the XL ALPIN CHALET but has sleeping nests just like those in the classic ALPIN CHALET.

The architecture, style, furnishings and the equipment provided are the same as in the other ALPIN CHALETs with the ALPIN LOFT as a highlight, providing romantic living space under the open gables. Prior to that, is the large terrace with sofas, picnic tables and barbecue area.

On the ground floor of the ALPIN CHALETs Large in Filzmoos there is an indoor pool with sun terrace for all guests of the ALPIN CHALETs at this location.

In Kleinarl, an outdoor pool invites guests of the three ALPIN CHALETs Large to swim in summer.



COZY SLEEPING NESTS



The **ALPIN CHALET "Large"** in Filzmoos has 8 sleeping nests. Each of the downstairs sleeping nests can sleep 1 to 4 persons. They all have a shower/WC and the bedroom has one normal double bed and a smaller double (140cm wide) which, if not needed as a bed, can be used as a sofa. Each of the 8 sleeping nests can be used as a single, double, triple or 4-bed room according to the group's needs.

Three additional bedrooms

If the group is bigger or more bedrooms are needed, there are three more rooms (on the floor below) which can be individually rented.



Panoramic indoor pool with sun terrace

with slide-glass fronts, whirl benches, waterfall, heated benches and sunbeds (please turn over).









LIVING AREA IN THE ALPIN CHALET "LARGE"

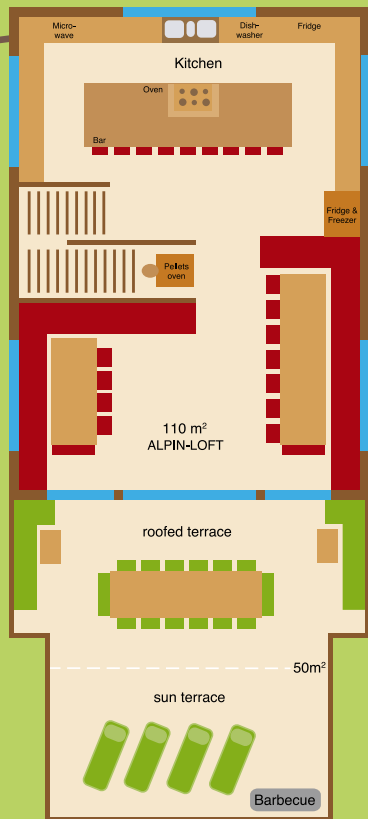

SLEEPING AREA IN THE ALPIN CHALET "LARGE"

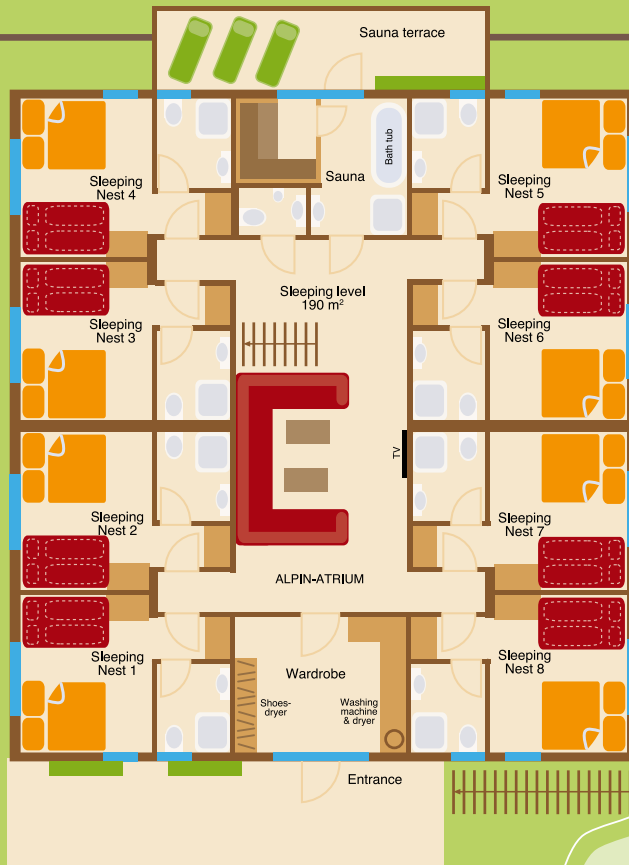



EXTRA ROOMS

Small studio apartments as extra rooms.

They are ideally positioned and arranged for any or all of the following group of combinations: You are all couples and one or two more double rooms would be perfect or you bring your grandmother with you, who likes to retreat into her own area. You bring your nanny/child-minder, your cook or your housekeeper along, who needs her/his own room. Your company arranges a seminar for your team with 11 people and you need single rooms for all of them, ...

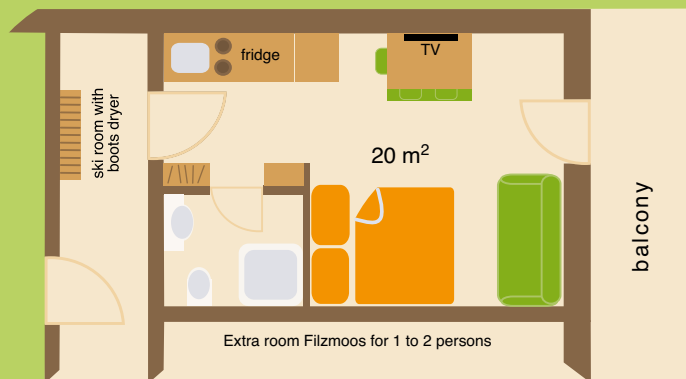

The two extra rooms in Filzmoos and the three in Kleinarl are situated next door to the ALPIN CHALETs on the pool level.

The prices can be found on the previous page.









POWER SPOTS IN FILZMOOS







KRAFTPLÄTZE IN KLEINARL





ALL ALPIN CHALETs IN SKI AMADÉ IN THE SALZBURG REGION

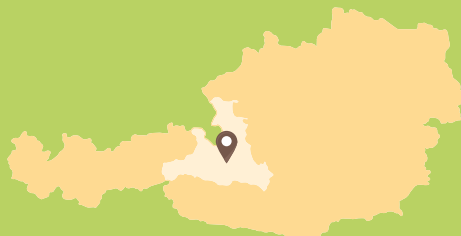



Kleinarl • 3 ALPIN CHALETs Large & 3 extra rooms, outdoorpool in summer

adress: 5603 Kleinarl, Dorf 11

The ALPIN CHALETs Large Kleinarl are located right at the beginning of the small village on the left in a free, sunny south-west position, behind the Kleinarl Ark - a clear, rushing brook. The view from the Alpine Lofts in the chalets to the Ennskraxn and the Kleinarl valley is impressive. The car is parked in the underground car park. Restaurants, bars and a well-stocked supermarket, with many regional products are within easy walking distance. A private sauna in the chalet. In addition, daily free entrance to the water world Wagrain. **Winter:** ALPIN CHALETs - Always 5-Edelweiss-Standard - Always in great locations - In the middle of the Ski Amade - Very close to the lift. In winter, directly at the practice lift and the beginners' slope. This lift is a short feeder lift to the „Champion Shuttle“ - the entry lift to the ski area Shuttleberg Flachauwinkl-Kleinarl and Zauchensee. With the gondola „Panorama Link“ connected with Snowspace Flachau-Wagrain-St. Johann Alpendorf. So perfect ski in - ski out to the largest connected ski area in Ski Amadé. **Summer:** The ALPIN CHALETs in Kleinarl has a heated outdoor pool with waterfall and whirlpool benches. The entrance to the bike path to Jägersee or to Wagrain is opposite, as well as the climbing world with high ropes course and flying fox. The Shuttleberg and bike rental are within easy walking distance. Directly from the location you can make many bike and hiking trips.



ALPIN CHALET GMBH

RESERVATION OFFICE

Höchweg 152 ❁ A-5542 Flachau

Tel +43(0)6457 307912

info@alpin-chalet.com

www.alpin-chalet.com

Filzmoos • 2 ALPIN CHALETs Classic & 1 ALPIN CHALE Large & 2 extra rooms, indoorpool

adress: 5532 Filzmoos, Vorderrain 5

The ALPIN CHALET's are located on the outskirts of this small hamlet, alone and idyllic at the edge of the woods. Neuberg is integrated into the village of Filzmoos with connecting ski buses, ski lifts, cross-country skiing trails, hiking buses, bike routes and so on. Filzmoos is situated in the heart of Salzburg County near to the Dachstein Region. In summer it is the ideal starting point for hiking, Nordic walking and mountain-bike tours. In winter two ski lifts which are just 150m from the chalets (Schwaigalm T-bar and the Geierberg T-bar) connect you to the Filzmoos ski area. At both lift stations you will find a ski bus stop. The ski area is pleasant, easy to find your way around and never over-crowded. Filzmoos is part of the world famous Ski amadé ski circuit and it's central position in the circuit makes it perfect for day trips to other ski areas. The nearest ski areas in the circuit, Schladming Planai, Reiteralm, Flachau - Wagrain - St. Johann, Flachauwinkl - Kleinarl – Zauchensee, are just a 20 minute car ride away.